

SA's Leading Past Year

Exam Paper Portal



You have Downloaded, yet Another Great Resource to assist you with your Studies 😊

Thank You for Supporting SA Exam Papers

Your Leading Past Year Exam Paper Resource Portal

Visit us @ www.saexampapers.co.za



**SA EXAM
PAPERS**
SA EXAM
PAPERS



GAUTENG PROVINCE

EDUCATION
REPUBLIC OF SOUTH AFRICA

GAUTENG PAPER 2

ENGINEERING GRAPHICS AND DESIGN P2

JUNE 2024

MARKING GUIDELINES

MARKS: 100

These marking guidelines consist of 6 pages.

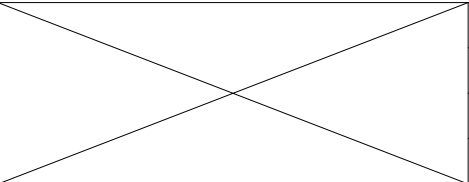
ANSWERS			
1	J24/62.LC	1	
2	600	1	
3	www.hooks@web.co.za	1	
4	12	1	
5	NONE	1	
6	CAD	1	
7	1 : 3	1	
8	KAREL	1	
9	INSERT BALL BEARING	1	
10	A: 108 ✓ B: 14 ✓ C: 160 ✓ D: 36 x 0,1 = 3,6 ✓	5	
11	120°	1	
12	BOTTOM VIEW	1	
13	$\varnothing 36 + 0,21 = \varnothing 36,21$	2	
14	$\varnothing 88 - 0,08 = \varnothing 87,92$	2	
15	8	1	
16	REVOLVED	1	
17	REMOVED	1	
18		D	1
		J	1
		G	1
		A	1
19	SEE BELOW	3	
TOTAL		30	

ANSWER 19

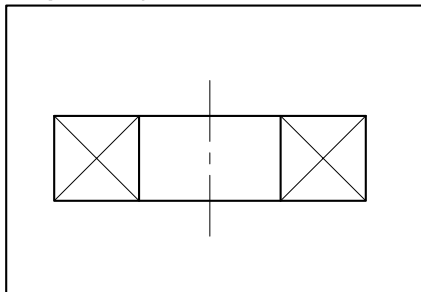

COMPLETE RECTANGLE	0.5
2 x SQUARES	0.5 + 0.5
2 x CROSSES	0.5 + 0.5
FREEHAND	<u>0.5</u>
	3



ASSESSMENT CRITERIA

1	AUX. VIEW AND PLACING	3
2	BASE	13 1/2
3	UPRIGHT	8 1/2
4	SECTION AND HATCHING	7
5	ISOMETRIC CIRCLES AND CENTRE LINES	7
PENALTIES (-)		
TOTAL		39

PAPER 2 QUESTION 2
 GRADE 12
 JUNIE 2024
 MARKING GUIDELINE

PLACEMENT / ORIENTATION

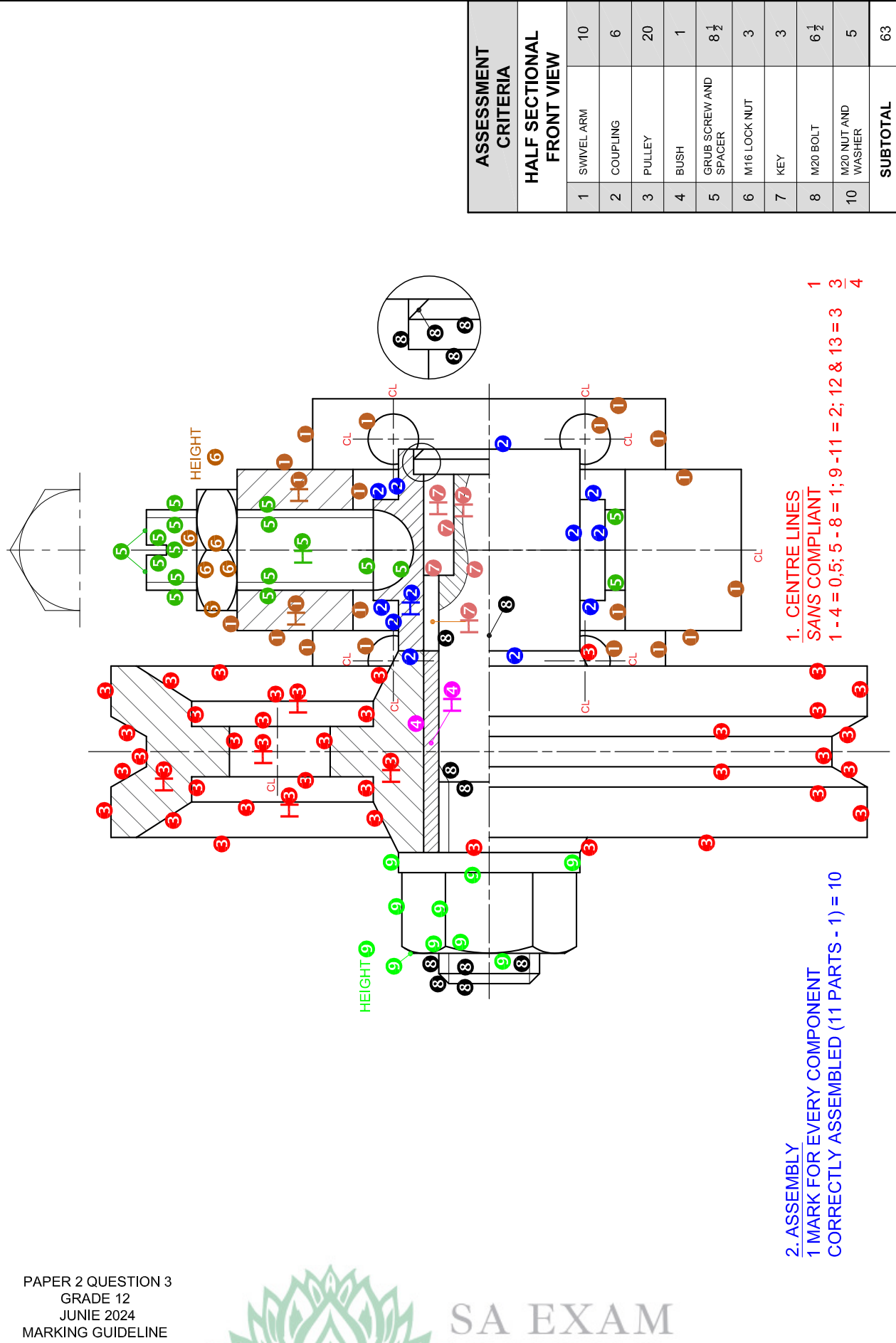

ASSESSMENT CRITERIA	
HALF SECTIONAL FRONT VIEW	
1	SWIVEL ARM 10
2	COUPLING 6
3	PULLEY 20
4	BUSH 1
5	GRUB SCREW AND SPACER 8 1/2
6	M16 LOCK NUT 3
7	KEY 3
8	M20 BOLT 6 1/2
10	M20 NUT AND WASHER 5
SUBTOTAL 63	

1. CENTRE LINES
 SANS COMPLIANT
 1 - 4 = 0,5; 5 - 8 = 1; 9 - 11 = 2; 12 & 13 = 3 3 4

2. ASSEMBLY
 1 MARK FOR EVERY COMPONENT
 CORRECTLY ASSEMBLED (11 PARTS - 1) = 10

PAPER 2 QUESTION 3
 GRADE 12
 JUNIE 2024
 MARKING GUIDELINE



SA EXAM PAPERS

ASSESSMENT CRITERIA	
LEFT VIEW	
1 SWIVEL ARM	5
2 PULLEY	4 ½
3 M20 NUT, BOLT AND WASHER	4 ½
SUBTOTAL	14
GENERAL	
1 CENTRE LINES	4
2 ASSEMBLY	10
SUBTOTAL	14
TOTAL	91

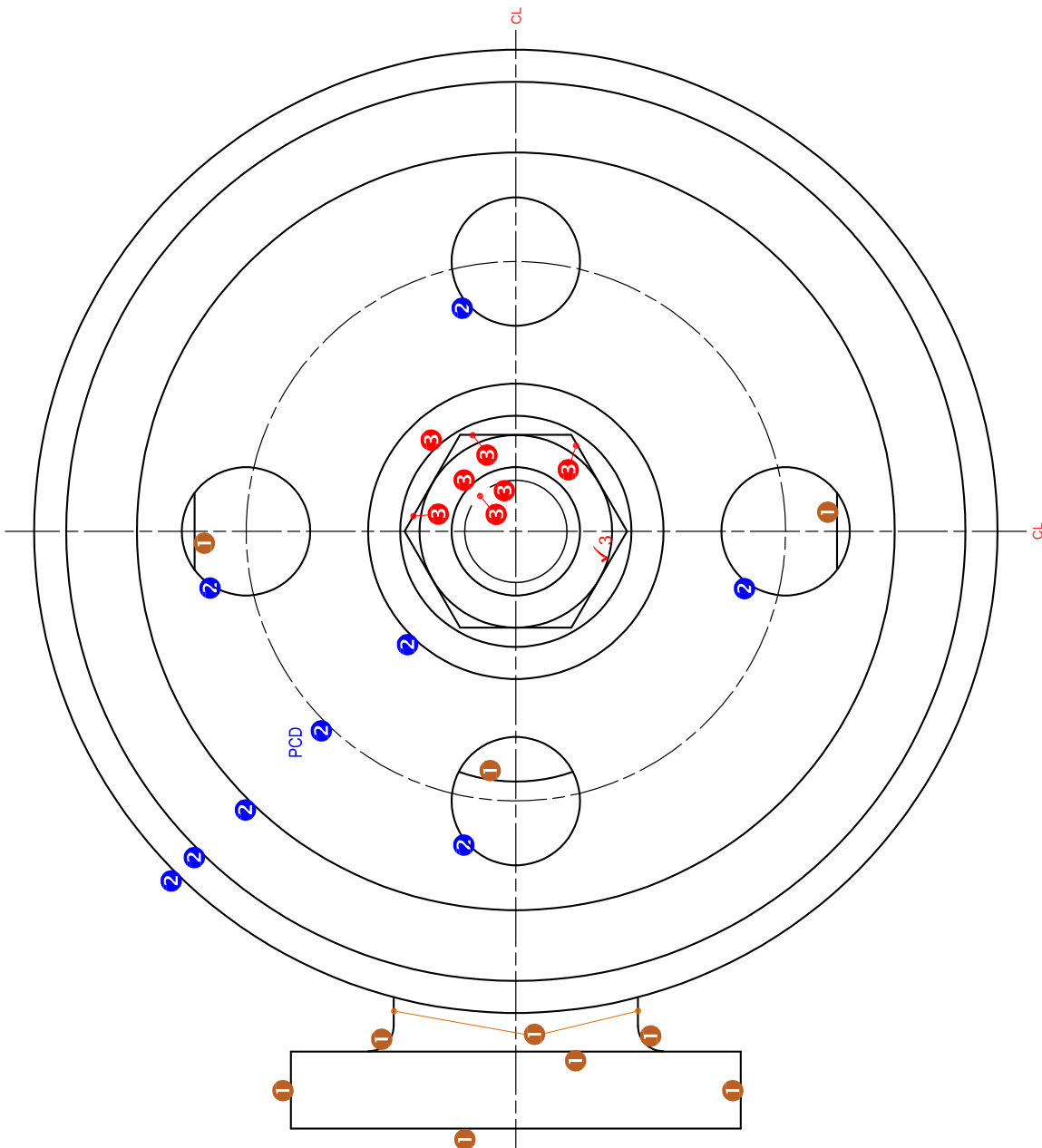

PAPER 2 QUESTION 3
 GRADE 12
 JUNIE 2024
 MARKING GUIDELINE



SA EXAM
 PAPERS